

Interlocking Channel

● Features

Heavy duty adjustable height system for mounting curtain wall in exterior applications.

Easy fit engagement for locating.

19.05mm clearance required above the panel.

Compatible with heavy duty hex bolts up to 9.52mm for additional strength.

Perfect for mounting on concrete block or other difficult material.

● Mechanical Information

	Imperial	Metric
Weight	0.35lb/ft	0.52kg/m
Projection	1in	25.4mm
Height	3in (4in combined)	76.2mm (101.6 mm combined)
Thickness	0.06in	1.58mm
Maximum Length	120in	3,048mm
Lift Off	0.62in	15.75mm
Alloy Type	6063-T6	
Anodizing	Min. 15µm	
Production Method	Extruded	

● Section View

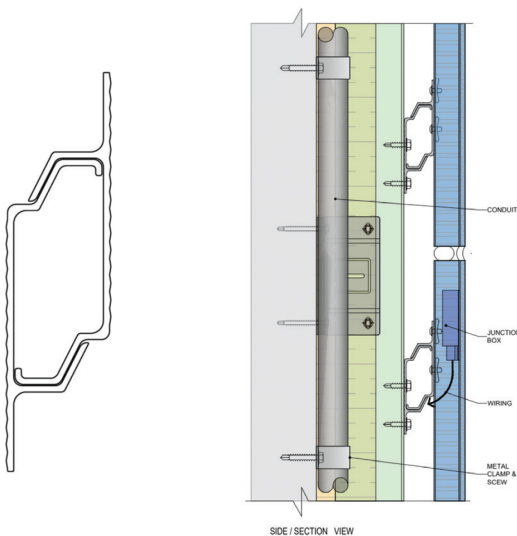

● Technical Drawing

